

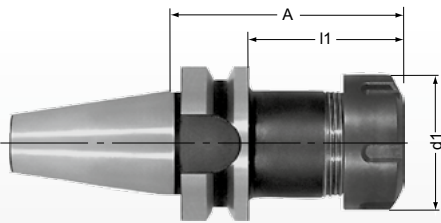



Spannzangenfutter MAS-BT30 - 50 für Spannzangen ER 16/25/32/40 mit Spannmutter UM

collet chucks MAS-BT30 - 50 for collets ER 16/25/32/40 with nut type UM
 mandrin à pinces MAS-BT30 - 50 pour pinces ER 16/25/32/40



Lieferumfang: BT-Aufnahme mit Spannmutter UM
 delivery: collet chuck with nut UM
 entendue de livraison: attachement avec ecrou UM



Bestell-Nr. order number No.	MAS	ER	d1	l1	A				
910 - BT3050	BT30	16	28	28	50	953-UM16	948-M10	954-034	G6,3/8.000
910 - BT3070		16	28	48	70	953-UM16	948-M10	954-034	
912 - BT3070		25	42	48	70	953-UM25	948-M12	954-013ER25	
912 - BT4060	BT40	25	42	33	60	953-UM25	948-M12	954-013ER25	
913 - BT4070		32	50	43	70	953-UM32	948-M16	954-014ER32	
914 - BT4080		40	63	53	80	953-UM40	948-M16	954-015ER40	
913 - BT5070	BT50	32	50	32	70	953-UM32	948-M16	954-014ER32	
914 - BT5080		40	63	42	80	953-UM40	948-M16	954-015ER40	

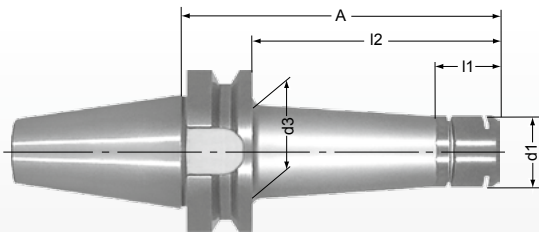

Spannzangenfutter MAS-BT30, 40 für Spannzangen ER 20 mit Spannmutter MS

collet chucks MAS-BT30, 40 for collets ER 20 with nut type MS
mandrin à pinces MAS-BT30, 40 pour pinces ER 20



Lieferumfang: BT-Aufnahme mit Spannmutter MS
delivery: collet chuck with nut MS
entendue de livraison: attachement avec ecrou MS



Bestell-Nr. order number No.	MAS	d1	d3	I1	I2	A			
911 - BT3040	BT30	28	33	30	40	62	953-MS20	954-063E20	G2,5/15.000 oder/or U<1gmm
911 - BT3080		28	39	30	80	102	953-MS20	954-063E20	
911 - BT4050	BT40	28	33	30	50	77	953-MS20	954-063E20	
911 - BT40100		28	35	30	100	127	953-MS20	954-063E20	
911 - BT40150		28	36	30	150	177	953-MS20	954-063E20	
911 - BT40200		28	36	30	200	227	953-MS20	954-063E20	