

# Fräsaufnahmen MAS-BT30 für Einschraubfräser

shank MAS-BT30 for threaded type cutter

mandrin MAS-BT30 pour fraises à queue filetée

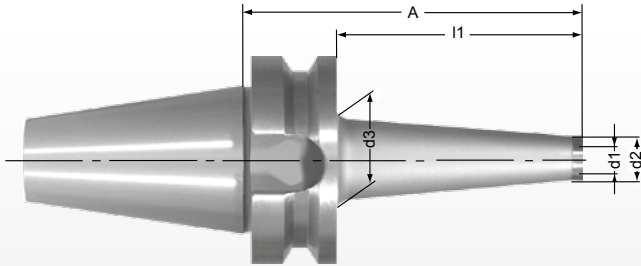

| Bestell-Nr.<br>order number<br>No. | d1  | d2 | d3 | A  | l1 | G6,3/10.000 |
|------------------------------------|-----|----|----|----|----|-------------|
| 962 - BT300825                     | M8  | 14 | 18 | 47 | 25 |             |
| 962 - BT300850                     | M8  | 14 | 23 | 72 | 50 |             |
| 962 - BT301025                     | M10 | 18 | 23 | 47 | 25 |             |
| 962 - BT301050                     | M10 | 18 | 27 | 72 | 50 |             |
| 962 - BT301225                     | M12 | 21 | 25 | 47 | 25 |             |
| 962 - BT301250                     | M12 | 21 | 31 | 72 | 50 |             |
| 962 - BT301625                     | M16 | 29 | 29 | 47 | 25 |             |
| 962 - BT301650                     | M16 | 29 | 34 | 47 | 50 |             |

# Fräsaufnahmen MAS-BT40 für Einschraubfräser

shank MAS-BT40 for threaded type cutter

mandrin MAS-BT40 pour fraises à queue filetée

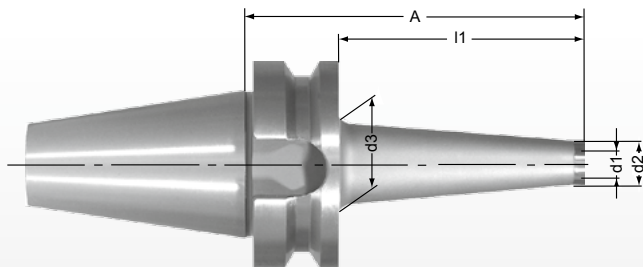

| Bestell-Nr.<br>order number<br>No. | d1  | d2   | d3   | A   | l1  | G6,3/10.000 |
|------------------------------------|-----|------|------|-----|-----|-------------|
| 962 - 0625BT                       | M6  | 10   | 17   | 52  | 25  |             |
| 962 - 0625BTZY                     | M6  | 10   | 10   | 52  | 25  |             |
| 962 - 0650BT                       | M6  | 10   | 23   | 77  | 50  |             |
| 962 - 0675BT                       | M6  | 10   | 25   | 102 | 75  |             |
| 962 - 0825BT                       | M8  | 13,8 | 18   | 52  | 25  |             |
| 962 - 0825BTZY                     | M8  | 13,8 | 13,8 | 52  | 25  |             |
| 962 - 0850BT                       | M8  | 13,8 | 23   | 77  | 50  |             |
| 962 - 0850BTZY                     | M8  | 13,8 | 13,8 | 77  | 50  |             |
| 962 - 0875BT                       | M8  | 13,8 | 25   | 102 | 75  |             |
| 962 - 0875BTZY                     | M8  | 13,8 | 13,8 | 102 | 75  |             |
| 962 - 08100BT                      | M8  | 13,8 | 30   | 127 | 100 |             |
| 962 - 08125BT                      | M8  | 13,8 | 34   | 152 | 125 |             |
| 962 - 1025BT                       | M10 | 18   | 23   | 52  | 25  |             |
| 962 - 1025BTZY                     | M10 | 18   | 18   | 52  | 25  |             |
| 962 - 1050BT                       | M10 | 18   | 25   | 77  | 50  |             |
| 962 - 1050BTZY                     | M10 | 18   | 18   | 77  | 50  |             |
| 962 - 1075BT                       | M10 | 18   | 30   | 102 | 75  |             |
| 962 - 1075BTZY                     | M10 | 18   | 18   | 102 | 75  |             |
| 962 - 10100BT                      | M10 | 18   | 35   | 127 | 100 |             |
| 962 - 10100BTZY                    | M10 | 18   | 18   | 127 | 100 |             |
| 962 - 10125BT                      | M10 | 18   | 40   | 152 | 125 |             |
| 962 - 10150BT                      | M10 | 18   | 45   | 177 | 150 |             |

# Fräsaufnahmen MAS-BT40 für Einschraubfräser

shank MAS-BT40 for threaded type cutter  
mandrin MAS-BT40 pour fraises à queue filetée

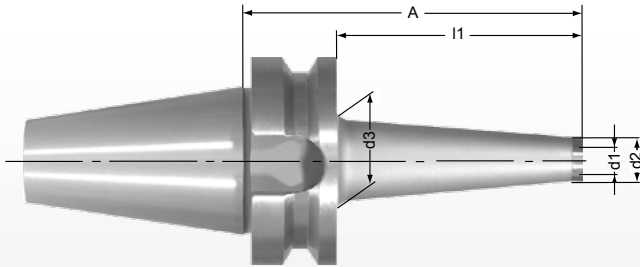

| Bestell-Nr.<br>order number<br>No. | d1  | d2 | d3 | A   | l1  | G6,3/10.000 |
|------------------------------------|-----|----|----|-----|-----|-------------|
| 962 - 1225BT                       | M12 | 21 | 24 | 52  | 25  |             |
| 962 - 1250BT                       | M12 | 21 | 30 | 77  | 50  |             |
| 962 - 1250BTZY                     | M12 | 22 | 22 | 77  | 50  |             |
| 962 - 1275BT                       | M12 | 21 | 35 | 102 | 75  |             |
| 962 - 1275BTZY                     | M12 | 22 | 22 | 102 | 75  |             |
| 962 - 12100BT                      | M12 | 21 | 38 | 127 | 100 |             |
| 962 - 12100BTZY                    | M12 | 22 | 22 | 127 | 100 |             |
| 962 - 12125BT                      | M12 | 21 | 43 | 152 | 125 |             |
| 962 - 12150BT                      | M12 | 21 | 45 | 177 | 150 |             |
| 962 - 1625BT                       | M16 | 29 | 29 | 52  | 25  |             |
| 962 - 1650BT                       | M16 | 29 | 34 | 77  | 50  |             |
| 962 - 1650BTZY                     | M16 | 29 | 29 | 77  | 50  |             |
| 962 - 1675BT                       | M16 | 29 | 35 | 102 | 75  |             |
| 962 - 1675BTZY                     | M16 | 29 | 29 | 102 | 75  |             |
| 962 - 16100BT                      | M16 | 29 | 40 | 127 | 100 |             |
| 962 - 16100BTZY                    | M16 | 29 | 29 | 127 | 100 |             |
| 962 - 16125BT                      | M16 | 29 | 44 | 152 | 125 |             |
| 962 - 16125BTZY                    | M16 | 29 | 29 | 152 | 125 |             |
| 962 - 16150BT                      | M16 | 29 | 45 | 177 | 150 |             |
| 962 - 16175BT                      | M16 | 29 | 50 | 202 | 175 |             |
| 962 - 16200BT                      | M16 | 29 | 50 | 227 | 200 |             |
| 962 - 16225BT                      | M16 | 29 | 50 | 252 | 225 |             |
| 962 - 16250BT                      | M16 | 29 | 50 | 277 | 250 |             |

# Fräsaufnahmen MAS-BT50 für Einschraubfräser

shank MAS-BT50 for threaded type cutter  
mandrin MAS-BT50 pour fraises à queue filetée

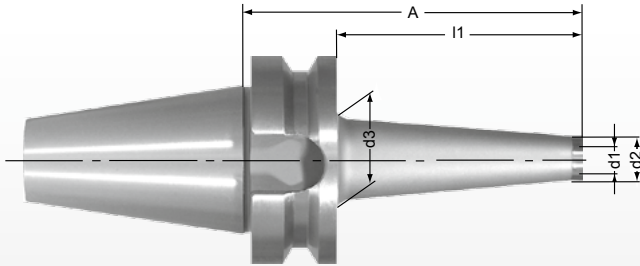

| Bestell-Nr.<br>order number<br>No. | d1  | d2   | d3 | A   | l1  | G6,3/8.000 |
|------------------------------------|-----|------|----|-----|-----|------------|
| 963 - 0850BT                       | M8  | 13,8 | 23 | 88  | 50  |            |
| 963 - 08100BT                      | M8  | 13,8 | 30 | 138 | 100 |            |
| 963 - 08150BT                      | M8  | 13,8 | 35 | 188 | 150 |            |
| 963 - 1050BT                       | M10 | 18   | 25 | 88  | 50  |            |
| 963 - 10100BT                      | M10 | 18   | 35 | 138 | 100 |            |
| 963 - 10150BT                      | M10 | 18   | 38 | 188 | 150 |            |
| 963 - 1250BT                       | M12 | 21   | 34 | 88  | 50  |            |
| 963 - 1250BTZY                     | M12 | 22   | 22 | 88  | 50  |            |
| 963 - 1275BT                       | M12 | 21   | 37 | 113 | 75  |            |
| 963 - 1275BTZY                     | M12 | 22   | 22 | 113 | 75  |            |
| 963 - 12100BT                      | M12 | 21   | 41 | 138 | 100 |            |
| 963 - 12100BTZY                    | M12 | 22   | 22 | 138 | 100 |            |
| 963 - 12150BT                      | M12 | 21   | 50 | 188 | 150 |            |
| 963 - 12200BT                      | M12 | 21   | 57 | 238 | 200 |            |
| 963 - 12250BT                      | M12 | 21   | 62 | 288 | 250 |            |
| 963 - 12300BT                      | M12 | 21   | 67 | 338 | 300 |            |
| 963 - 1650BT                       | M16 | 29   | 35 | 88  | 50  |            |
| 963 - 1650BTZY                     | M16 | 29   | 29 | 88  | 50  |            |
| 963 - 1675BT                       | M16 | 29   | 37 | 113 | 75  |            |
| 963 - 1675BTZY                     | M16 | 29   | 29 | 113 | 75  |            |
| 963 - 16100BT                      | M16 | 29   | 41 | 138 | 100 |            |
| 963 - 16100BTZY                    | M16 | 29   | 29 | 138 | 100 |            |
| 963 - 16150BT                      | M16 | 29   | 50 | 188 | 150 |            |
| 963 - 16150BTZY                    | M16 | 29   | 29 | 188 | 150 |            |
| 963 - 16200BT                      | M16 | 29   | 57 | 238 | 200 |            |
| 963 - 16200BTZY                    | M16 | 29   | 29 | 238 | 200 |            |
| 963 - 16250BT                      | M16 | 29   | 62 | 288 | 250 |            |
| 963 - 16300BT                      | M16 | 29   | 67 | 338 | 300 |            |